



2: MAIN POST, Ø76mm
STEEL PIPE.
QTY PER ASSEMBLY: 1No



POST GUARD
QTY PER ASSEMBLY: 1No



3: HYBRID MAIN SUPPORT
QTY PER ASSEMBLY: 1No



4: UC1 BRACKET, UPPER SUPPORT
QTY PER ASSEMBLY: 2No



5: COWCOON BASE LEG
QTY PER ASSEMBLY: 1No



6: CCT CLAMP INSERT
QTY PER ASSEMBLY: 1No



7: 76 X 60 BASE CLAMP
QTY PER ASSEMBLY: 2No



8: 70mm U-BOLT
QTY PER ASSEMBLY: 2No



9: 60mm U-BOLT
QTY PER ASSEMBLY: 2No



10: WALL MOUNT BRACKET
QTY PER ASSEMBLY: 2No



11: NECK BAR BRACKET
QTY PER ASSEMBLY: 1No



12: BOLTS FOR ITEM 4
M12X 25mm BZP BOLT
WITH NUT & WASHER
QTY PER ASSEMBLY: 6No



13: BOLTS FOR ITEM 4
M12X 90mm BZP BOLT
WITH NUT & WASHER
QTY PER ASSEMBLY: 3No

A		FIRST ISSUE	15/08/2012	AW
ZONE	REV.	DESCRIPTION	DATE	APPROVED
REVISIONS				
DRAWN BY		DL	DATE:	15.08.12
APPROVED		AW	DATE:	15.08.12
SHEET 1 OF 6		SCALE: 1:4	A1	
TITLE: COWCOON ASSEMBLY				
DWG NO.				REV.
12071-314				A



ITEM NO.	PART NUMBER	QTY.
1	Vertical Post	1
2	12071-506 (UC1 Clamp)	2
3	73 Inch	1
4	12071-501 (60X76 Single T-Clamp)	2
5	12071-502 (CCT Clamp Insert)	1
6	HDPE Base Leg (Config)	1
7	U Bracket (Config)	1
8	M10 x 25, BZP	6
9	Bright washer BS 4320 - M10 (Form A)	12
10	Hexagon Nut ISO - 4034 - M10 - N	9
11	12071-505 (Post Protection Sleeve)	1
12	70mm U-Bolt	2
13	Bright washer BS 4320 - M8 (Form A)	4
14	Hexagon Nut ISO - 4034 - M8 - N	4
15	M10 x 90mm, BZP	3

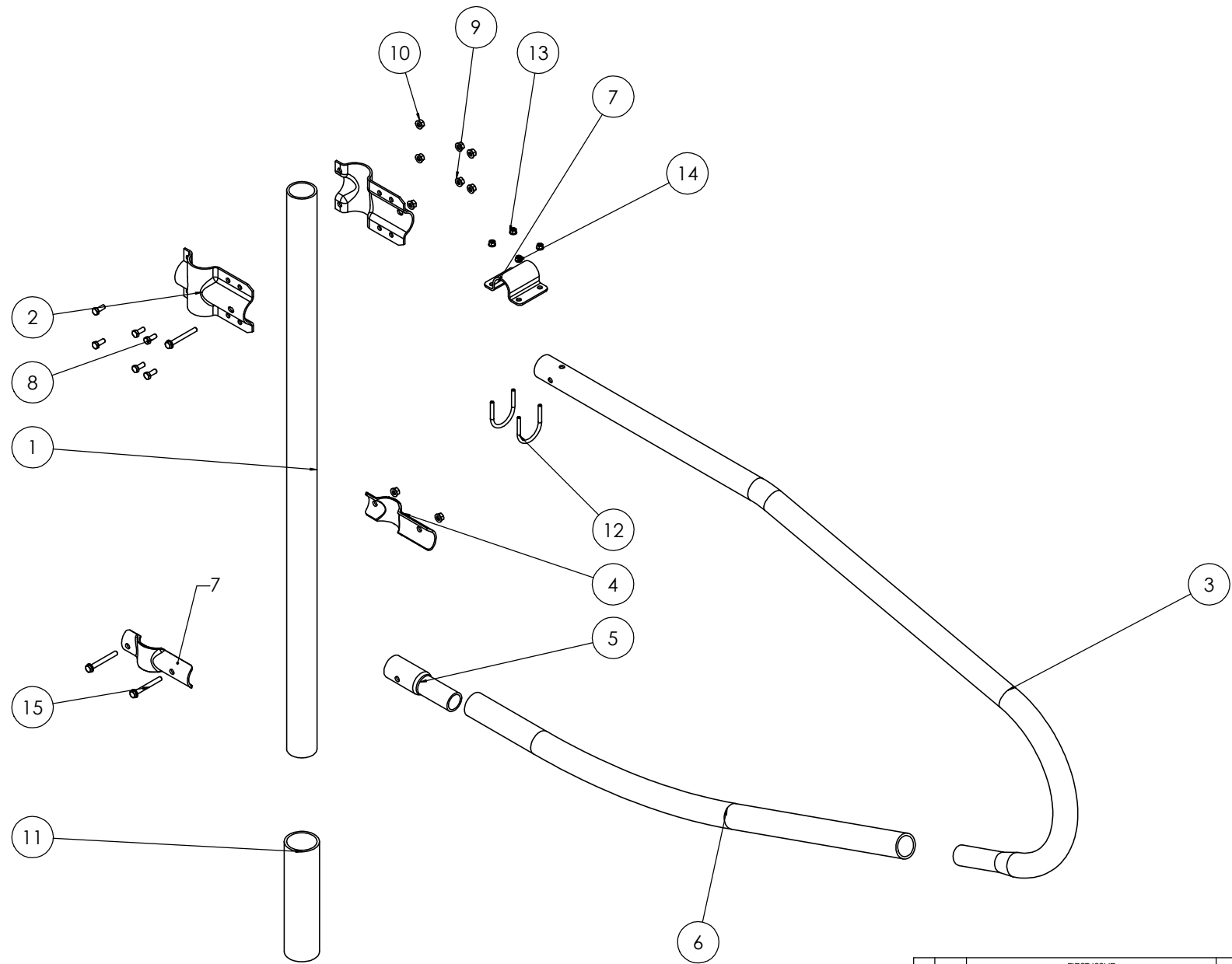

ZONE	REV.	DESCRIPTION	DATE	APPROVED
A		FIRST ISSUE	15/08/2012	AW
REVISIONS				
		DRAWN BY	DL	DATE: 15.08.12
		APPROVED	AW	DATE: 15.08.12
SHEET 2 OF 6		SCALE: 1:5	A1	
TITLE: COWCOON ASSEMBLY				
DWG NO.			REV.	
12071-314			A	



INSTALLATION STEP 1

- ALL POSTS CONCRETED IN AT CENTRES PROVIDED WITH ORDER CONFIRMATION.
- **ALWAYS** USE POST PROTECTION SLEEVES PROVIDED. FAILURE TO DO SO WILL COMPROMISE THE STRUCTURE.
- PLEASE SEE POST INSTALL DETAILS FOR FURTHER INFORMATION.



DETAIL A
SCALE 1 : 5

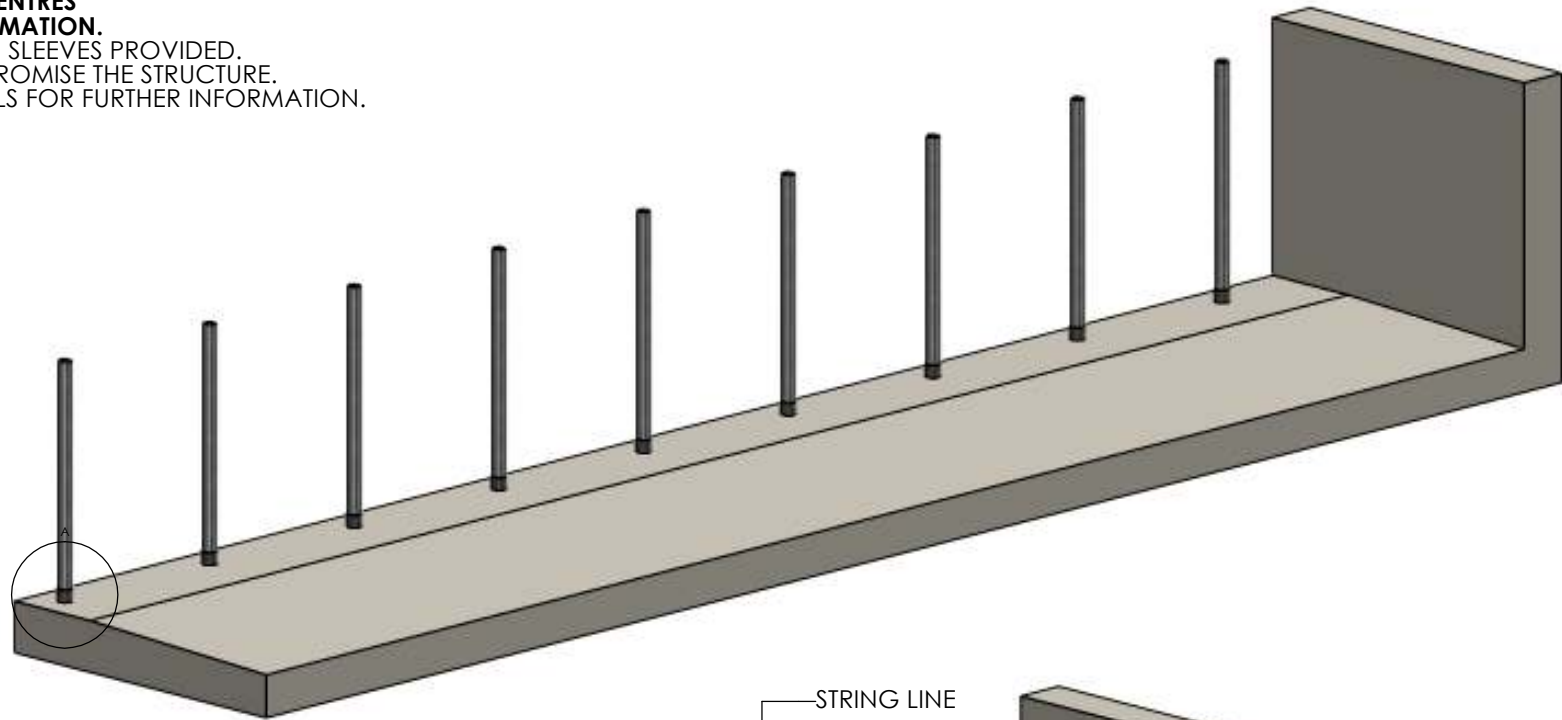

INSTALLATION STEP 2

- INSTALL OUTER MOST LOPS AND LEVEL AS PER HEIGHT PROVIDED WITH ORDER. (STANDARD 50").
- **NOTE:** HEIGHT IS FROM TOP OF BEDDING NOT CONCRETE FLOOR.
- TIGHTEN CLAMPS AND ENSURE RIGID FIX.
- <PARA >RUN STRING LINE BETWEEN OUTER LOOPS

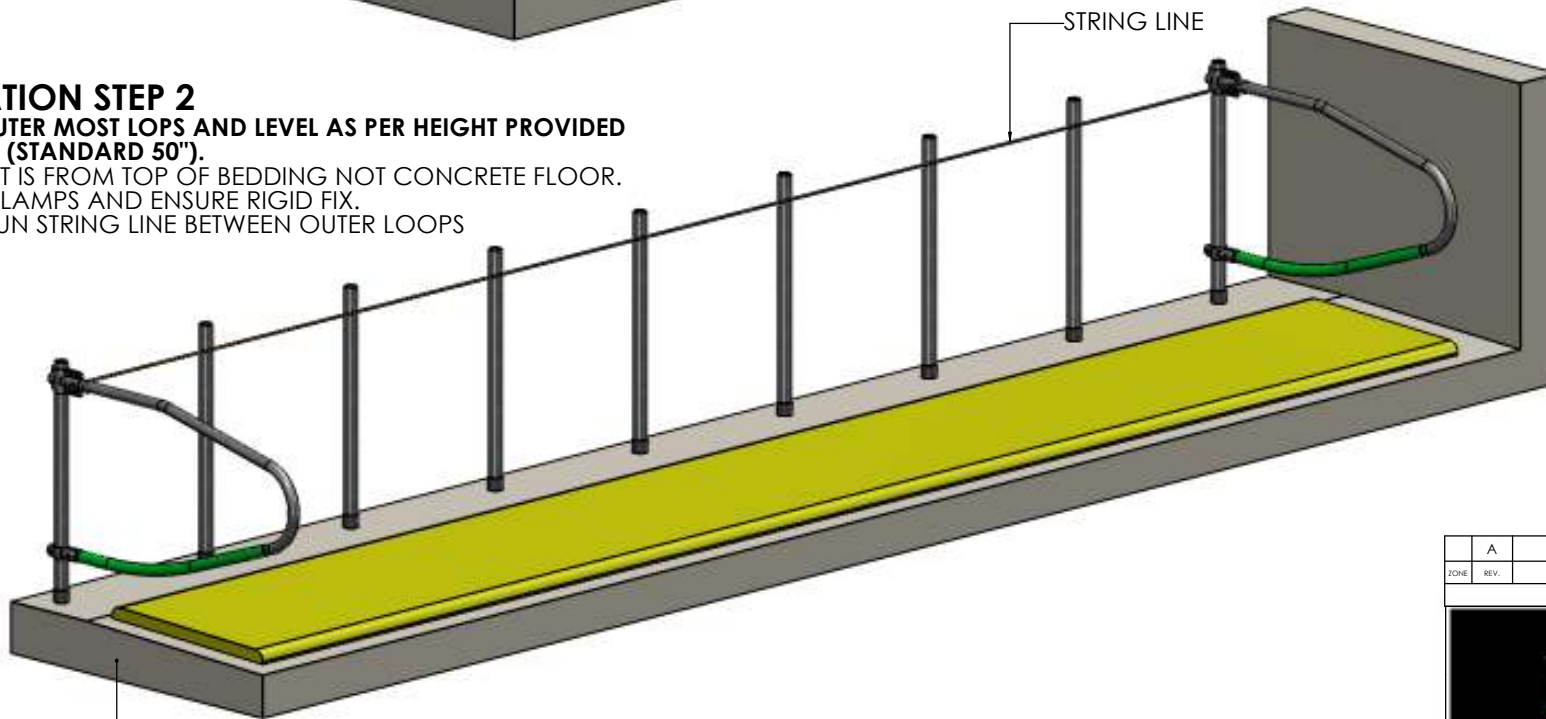

WALL OMITTED FOR CLARITY.
RIGID WALL FIXINGS REQUIRED AT BOTH ENDS OF STALLS.

A	FIRST ISSUE	15/08/2012	AW
ZONE	REV.	DESCRIPTION	DATE APPROVED
REVISIONS			
DRAWN BY	DL	DATE:	15.08.12
APPROVED	AW	DATE:	15.08.12
SHEET 3 OF 6		SCALE:1:15	A1
TITLE			
COWCOON ASSEMBLY			
DWG NO.			REV.
12071-314			A

**Wilson
Agri**

WWW.WILSONAGRI.COM

INSTALLATION STEP 3

- COMPLETE INSTALLATION OF REMAINING ASSEMBLIES USING STRING LINE TO ENSURE ALL REMAIN LEVEL.

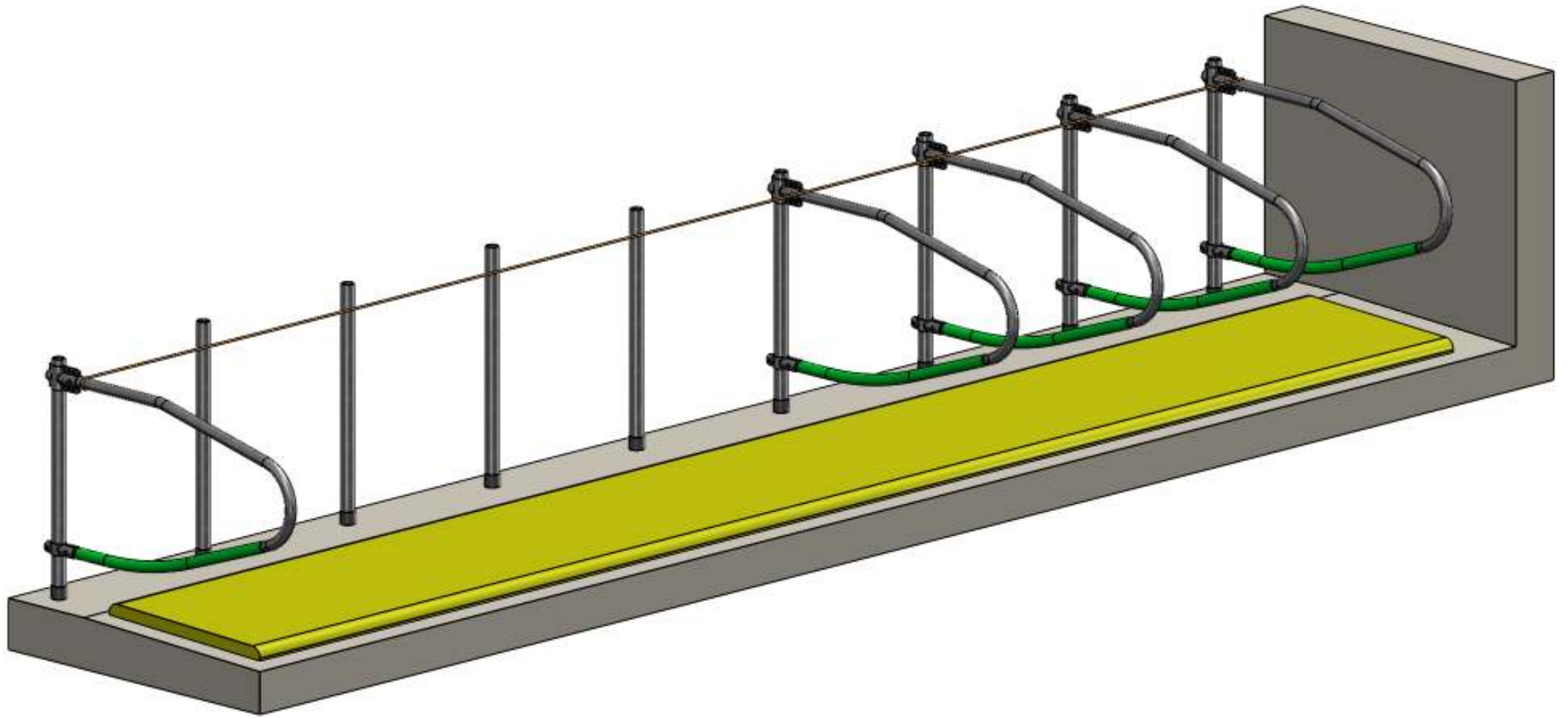

A	FIRST ISSUE	15/08/2012	AW
ZONE	REV.	DESCRIPTION	DATE APPROVED
REVISIONS			
DRAWN BY	DL	DATE:	15.08.12
APPROVED	AW	DATE:	15.08.12
SHEET 4 OF 6		SCALE:1:1	A1
TITLE: COWCOON ASSEMBLY			
DWG NO. 12071-314			REV. A



INSTALLATION STEP 4

- FIT TOP NECK BAR RACKET TO FIRST AND LAST AVAILABLE STAND ON LENGTH OF TUBE.
- NECK BAR TO BE FITTED IN ACCORDANCE WITH ORDER DOCUMENTATION. THE INFORMATION SUPPLIED AT TIME OF ORDER IS SPECIFIC TO YOUR REQUIREMENTS.

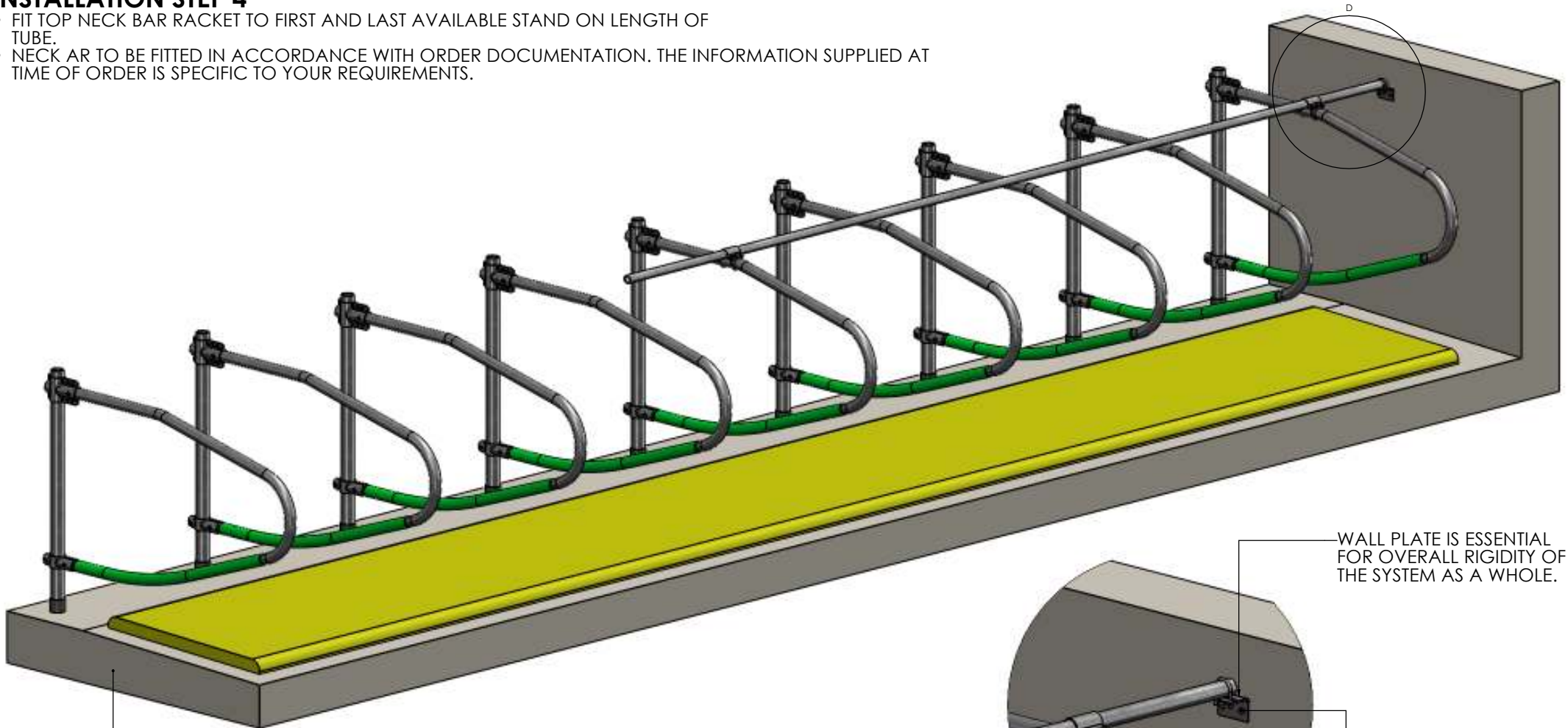

WALL PLATE IS ESSENTIAL FOR OVERALL RIGIDITY OF THE SYSTEM AS A WHOLE.

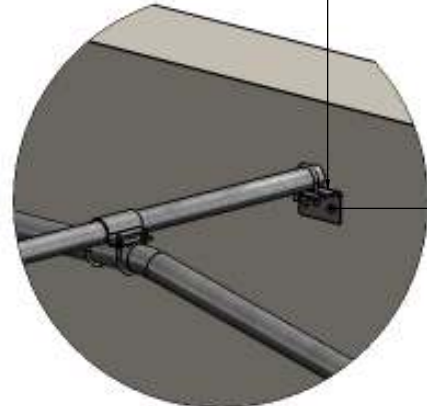

FITTED TO WALL USING 2 No M12 THUNDERBOLTS PROVIDED. 10mm MASONRY DRILL BIT REQUIRED.

WALL OMITTED FOR CLARITY. RIGID WALL FIXINGS REQUIRED AT BOTH ENDS OF STALLS.

DETAIL D
SCALE 2 : 1

A	FIRST ISSUE	15/08/2012	AW
ZONE	REV.	DESCRIPTION	DATE
REVISIONS			
DRAWN BY	DL	DATE:	15.08.12
APPROVED	AW	DATE:	15.08.12
SHEET 5 OF 6		SCALE:1:1	A1
TITLE			
COWCOON ASSEMBLY			
DWG NO.			REV.
12071-314			A



INSTALLATION STEP 5

- COMPLETE INTERMEDIATE TOP BAR CONNECTIONS.
- PLEASE REFER TO ORDER INFORMATION FOR DISTANCES AND HEIGHTS FOR TOP BAR TO SUIT INDIVIDUAL REQUIREMENTS.

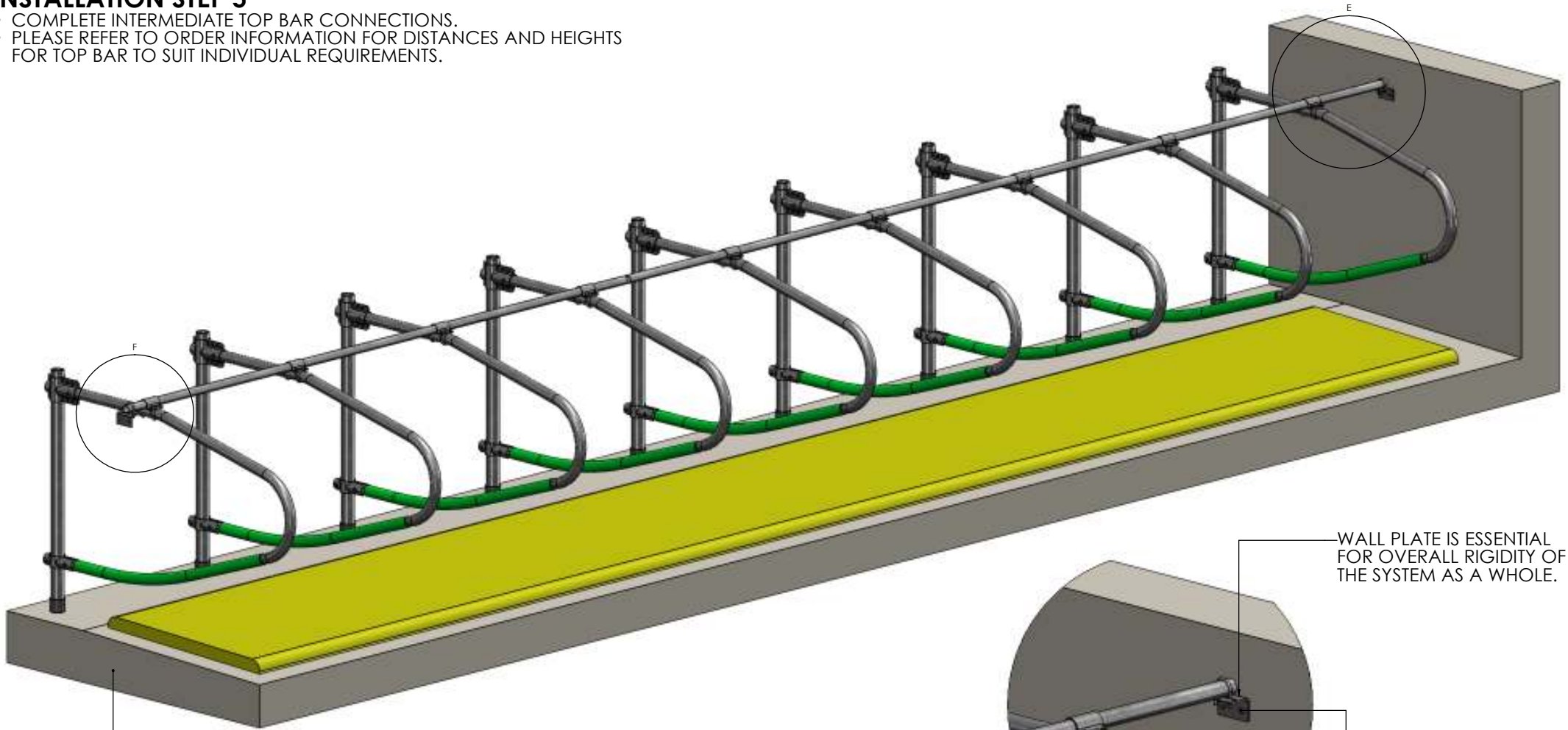

WALL OMITTED FOR CLARITY.
RIGID WALL FIXINGS REQUIRED AT BOTH ENDS OF STALLS.

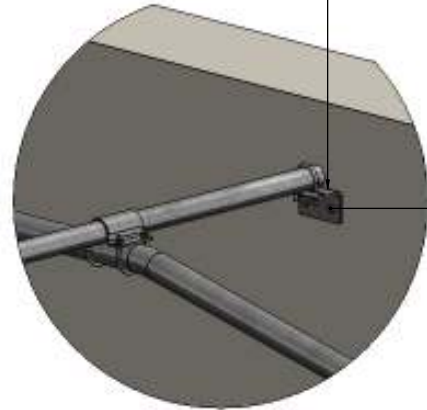

WALL PLATE IS ESSENTIAL FOR OVERALL RIGIDITY OF THE SYSTEM AS A WHOLE.

FITTED TO WALL USING 2No M12 THUNDERBOLTS PROVIDED.
10mm MASONRY DRILL BIT REQUIRED.

WALL PLATE FITTED AT BOTH ENDS.



DETAIL F
SCALE 2 : 11

DETAIL E
SCALE 2 : 11

ZONE	A	FIRST ISSUE	15/08/2012	AW
REV.		DESCRIPTION	DATE	APPROVED
REVISIONS				
DRAWN BY	DL	DATE:	15.08.12	
APPROVED	AW	DATE:	15.08.12	
SHEET 6 OF 6		SCALE:1:11	A1	
TITLE				
COWCOON ASSEMBLY				
DWG NO.			REV.	
12071-314			A	

